



**GENERAL NOTES**

THIS DRAWING TO BE READ IN CONJUNCTION WITH ARCHITECT'S DRAWINGS, CONSULTANT ENGINEERS DRAWINGS AND SPECIFICATIONS, AND LANDSCAPE ARCHITECT'S DRAWINGS AND SPECIFICATIONS.

FOR SITE LEVELS AND FINISHED FLOOR LEVELS REFER TO DBFL CONSULTING ENGINEERS DRAWINGS  
 FOR PRIVATE OPEN SPACE (REAR GARDENS) SIZES AND DETAILED INFORMATION ON SPACE PROVISIONS WITHIN HOUSES REFER TO McCrossan O'Rourke Manning architects Design Statement DOCUMENT

**LEGEND**

- SITE BOUNDARY OF PLANNING APPLICATION
- WAYLEAVE
- LANDS IN THE CONTROL OF THE APPLICANT / OWNER

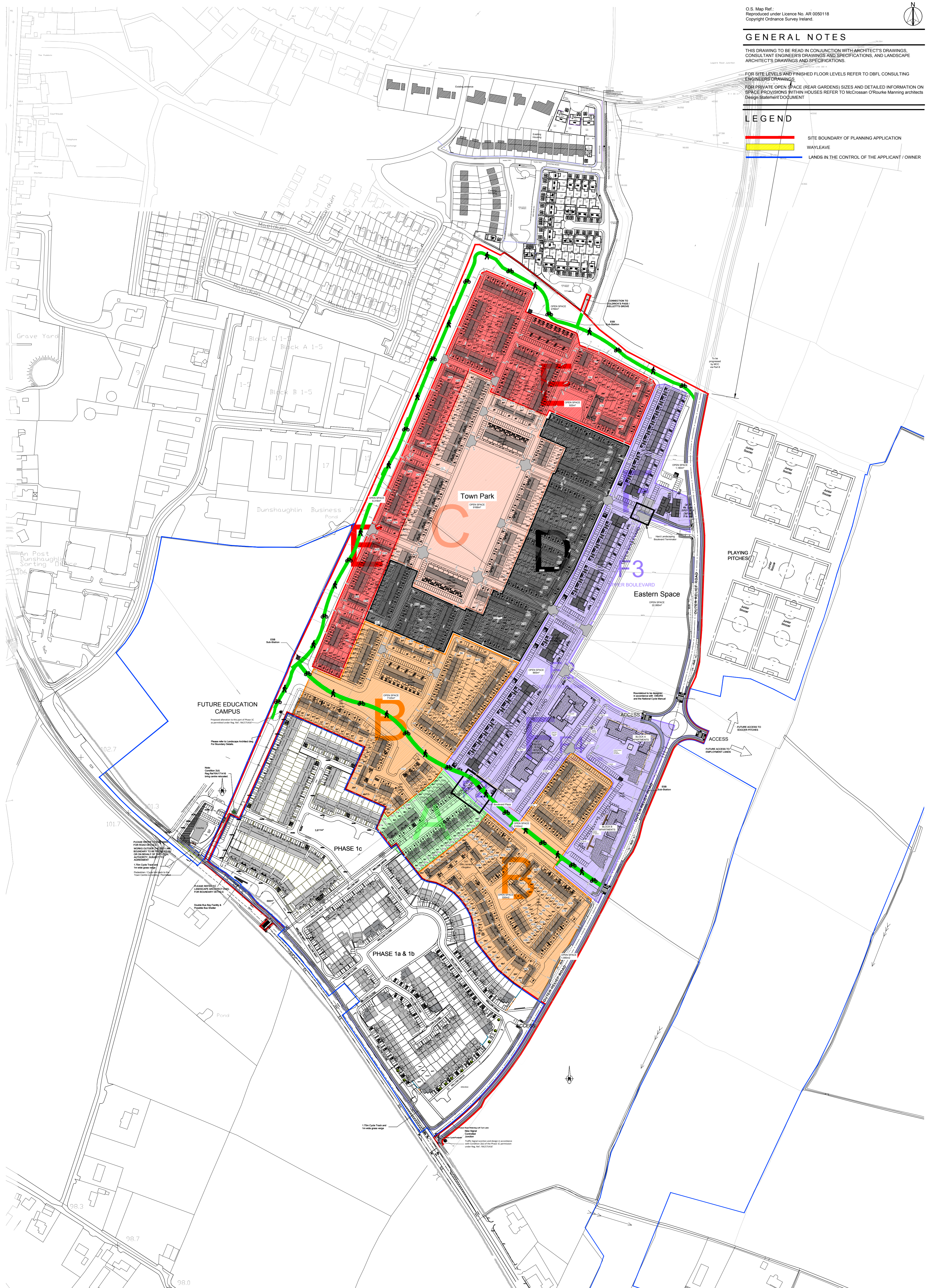

**NOTES:**  
 DO NOT SCALE FROM DRAWINGS. WORK TO FIGURED DIMENSIONS ONLY. ARCHITECT TO BE NOTIFIED OF ALL DISCREPANCIES.

REVISIONS		
DATE	DESCRIPTION	No.

**MCORM**  
 McCrossan O'Rourke Manning Architects

PROJECT TITLE: <b>Dunshaughlin East SHD</b>	DATE: DEC'18	DRAWN BY: DE
DRAWING TITLE: <b>SITE PLAN CHARACTER AREA</b>	SCALE: 1:2000@A	REVISION:
JOB NO: 16028.1	DRAWING NO: SHD11	

Albert Place West, Harcourt Lane, Dublin 2, Ireland.  
 Tel: 01-4788700 Fax: 01-4788711 E-Mail: arch@mcorm.com